

TARA POOL SAFETY COVER INSTALLATION GUIDE

Thank you for your purchase of a Tara safety cover. With proper installation and care, your safety cover will provide protection for years to come. To ensure that the safety cover is installed properly, Tara recommends that the initial safety cover installation be performed by a qualified pool professional.

IMPORTANT: These instructions are to be used as a guide only. It is recommended that at least (2) individuals install a cover.

IMPORTANT INFORMATION CONCERNING MESH MAINTENANCE

After installation, the safety cover must be inspected for debris accumulating on top of cover. As debris collects on top of the safety cover, the cover must be swept to ensure that rain water can drain into the pool. Failure to keep top of cover clear may cause water to puddle and failure of pool cover.

Included Hardware

1. Brass Anchors
 - a. Screw Type Anchor
 - b. Wood Anchor
2. Compression Springs w/D-Rings and Spring Covers
3. Anchor Tamping Tool
4. Installation Rod
5. Allen Wrench / Hex Key
6. Buckles

Required Installation Tools

- Heavy Duty Hammer Drill
- 3/4" Concrete Drill Bit (Carbide or Diamond Tipped)
- 3/8" and 1/2" Concrete Drill Bits (For Cable System Installations)
- Hammer
- Tape Measure
- Chalk Line (Note: Red chalk can leave a permanent mark)
- Chalk (Note: Red chalk can leave a permanent mark)
- Extension Cords
- Buckets (5-Gallon) or Sand Bags
- Spray Silicone
- Wooden Block

- It is best to have pool water at operating level for safety cover installation.
- Remove all handrails, ladders, etc.
- Position 5 gallon buckets filled with water around the pool.
- Lift the cover out of the box. Unroll the cover and stretch it over the pool. Secure the cover in place by **placing buckets on the straps only**. To prevent damage to the cover, do not drag it. The warning label should face up and the rub-strips should face down.
- Attach springs to all straps of the pool cover.

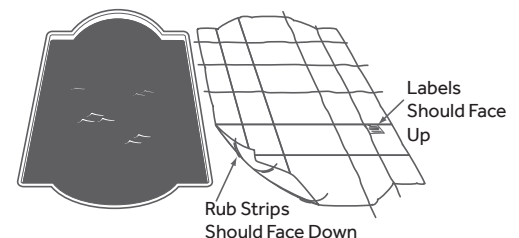

LACING SPRINGS TO STRAPS

Thread the strap through the spring and back through the buckle on the strap (see below). The distance between the edge of the cover and the spring should be 10". The distance can be adjusted later if needed.

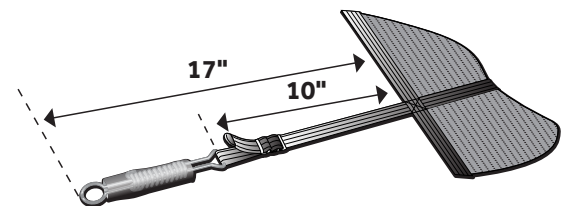

INSTALLING RECTANGULAR & FREE-FORM COVERS

IF YOUR POOL HAS ANY AREAS WITH CUT-OUTS OR RAISED WALL AREAS, INSTALL THESE AREAS FIRST. (See Raised Wall instructions on page 4)

STEP 1

Measure your pool and your new cover. Adjust the cover for equal overlap. The side to side and end to end overlap may be different, but side should equal side and end should equal end. If there are any obstructions (e.g. rocks, rails, raised walls), position the cover so that cutouts fit around obstructions.

Note: The actual overlap may vary from 11" to 14" due to stretching or shrinkage during shipping.

STEP 2

Starting with the center straps of the length and width, measure and mark the anchor positions on the deck approximately 20" from the edge of the cover. (See below)

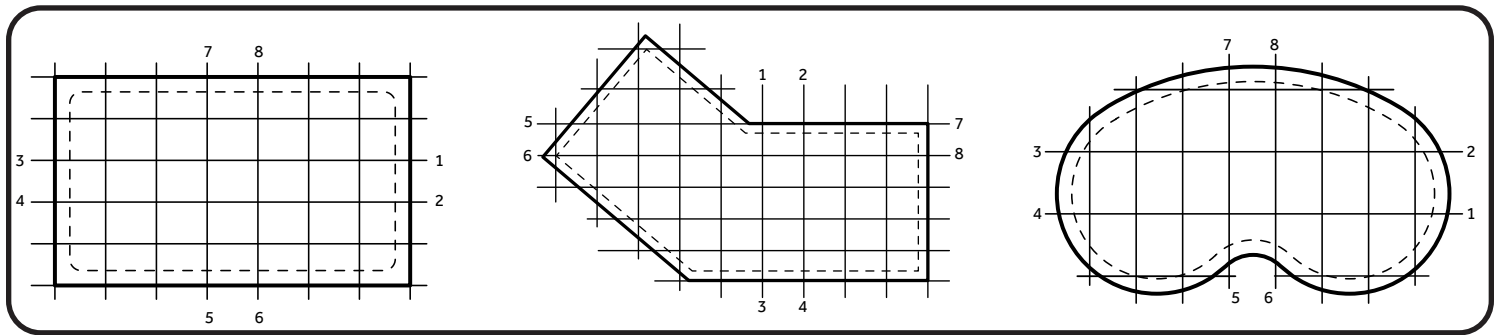

STEP 3

Install anchors and springs for straps 1, 2, 3 and 4. See below for anchor and spring installation. Attach springs to anchors using installation rod. Then do the same for straps 5, 6, 7 and 8. (See installing anchors on page 3)

STEP 4

Once the first 8 anchors are secured, locate and install the remaining anchors working from the middle of the cover and finishing with the ends. Alternate sides as you install each anchor and attach and secure each spring as you go. On rectangular pools, you can use a chalk line to ensure that all anchors are aligned. Snap the chalk line parallel to the perimeter of the pool using installed anchors as a guide.

STEP 5

After all the anchors have been installed and the springs are attached to the anchors, adjust the spring tension so that it is equal on each part of the cover. Check to make sure the overlap is equal all the way around and that the cover lies flat on the deck.

IMPORTANT:

The water level of the pool must not be more than 18" below the cover during snow season to provide support under the cover in case of a heavy snow load. Check the water level monthly. Letting the water level fall below 18" during snow season voids the warranty.

Solid covers with mesh drain panels require adjustment after installation to drain the water that collects on top. After the cover is installed, flood it with water. If standing water forms puddles that do not drain, simply loosen strap on either side of the drain and tighten straps in the areas with standing water.

INSTALLING ANCHORS

STEP 1

Use a hammer drill with a long 3/4" drill bit to drill holes for each of the anchors. The hole depth should be around 2" deep. You can use tape on the bit or a drill guide to maintain a consistent depth for your holes. Vacuum any dust from the hole before setting the anchor shell into the hole.

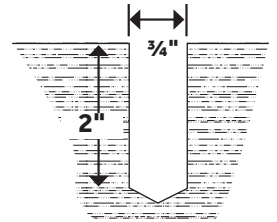

STEP 2

When your anchor hole is ready, remove the anchor screw from the shell. Spray silicone lightly on the anchor, anchor shell and tamping tool. The shell can be lightly tamped into position by inserting the tamping tool into the shell and tamping it into the deck with a mallet or hammer. Then insert the anchor screw into the anchor shell with the hex key.

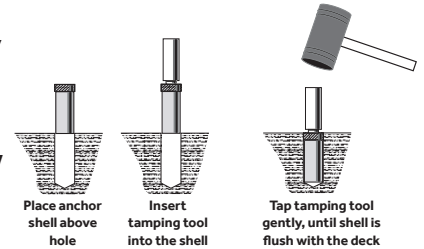

Anchoring Into Wood Decks

Use a Tara Wood Deck Anchor. First, to countersink the anchor, use a 1-1/2" paddle bit to drill a hole into the deck to a depth of 1/8". Then with a standard 3/4" drill bit, drill holes at least 2" deep, or through the deck, in the centers of the original 1-1/2" holes. Place the Wood Deck Anchor in the holes. Using Phillips head screws, fasten the anchor to the deck. Thread the anchor screws into the anchor shell until half of the screw is showing. (Attach springs as instructed below)

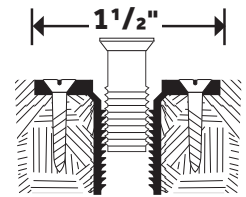

Anchoring Into Brick or Stone Pavers

Use a Tara Paver Tube. Before drilling into masonry, first try drilling a test piece. Drill a 1" diameter hole into the material to a depth of 15". Use a block of wood and mallet to tap the Paver Tube into the hole unit until it's flush with the deck surface. Then remove the anchor screw, lubricate it and screw it into the body of the anchor tube until only the un-threaded portion is showing. (Attach springs as instructed below)

Anchoring Into Lawns, Planters or Soil

Use a Tara Aluminum Lawn Stake. Aluminum Lawn Stakes are 1/2" round, 18" long, with a head at the top to hold a spring. To install, locate anchor position and using a block of wood and mallet, tap the Lawn Stake into place. (Attach springs as instructed below)

Please remember: Aluminum Lawn Stakes do not provide the same degree of safety as a standard anchor or paver tube assembly and should not be used for more than 20% of the anchoring points around a pool. Aluminum Lawn Stakes should also never be placed at opposite ends of the same strap.

FASTENING SPRINGS TO ANCHORS

STEP 1

Adjust the anchor insert to the up position with the hex key. Slide the installation rod through loop end of the cover spring and place the long tip end of the installation rod on the back side of the anchor (side farthest from the pool).

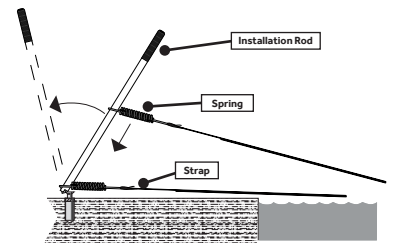

STEP 2

Pull the handle of the installation rod away from the pool. The spring will slide down the rod to the elongated tip. It is often helpful to push the spring down using your foot. The rod may also be lightly sprayed with a silicone lubricant to ease sliding. The spring will slide off the rod and onto the anchor head.

Cover should be drum-tight once all of the springs are fastened. If a cover is too loose, a child may be able to slip beneath. A loose cover may allow wind underneath. If the wind is able to whip the cover, the coping can wear on the fabric of the cover and damage it.

STEP 3

To unfasten the spring from the anchor, insert the notched tip of the installation rod in the open side of the spring and rotate it one half turn until it is between the anchor and the spring. Pull back on the installation rod to release the spring.

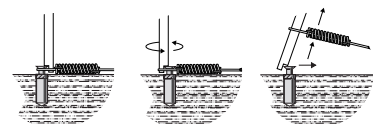

RAISED WALLS & WATER FEATURES

On pools with an obstruction that does not allow the cover to overlap the edge of the pool you can use a Tara cable kit. *Please Note: It is recommended that these areas be secured first before installing the rest of the cover.*

STEP 1

Determine where the first Cable Anchor Bolt will be installed in the wall. It should be level with the deck or about 1/4" above. Using the 1/2" drill bit, drill a hole 2-1/2" deep. The hole needs to be the full 2-1/2" depth to ensure that the Cable Anchor Bolt doesn't stick out too far.

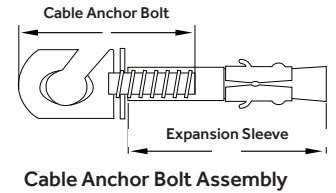

STEP 2

Remove the Cable Anchor Bolt from the expansion sleeve. Gently tap the expansion sleeve all the way into the hole.

STEP 3

Thread the Cable Anchor with the washer into the expansion sleeve. You can use a screwdriver to get leverage. The Cable Anchor should touch the wall and the cable slot should face upward.

STEP 4

Once you have the first Cable Anchor Bolt installed, install the rest. They should never be more than 18" apart. Some may need to be closer on outside radius so that the distance between the cable and the wall is not more than 2".

STEP 5

To install the cable, begin by installing a Stainless Steel Eye-Bolt into the deck at each end of the raised wall, approximately 18" back from the waters edge. You will use these to attach the turnbuckles on each end of the cable system (See Example 1). If you prefer, you can substitute a Brass Anchor for the Stainless Steel Eye-Bolt so that it can be recessed into the deck, when not in use (See Example 2).

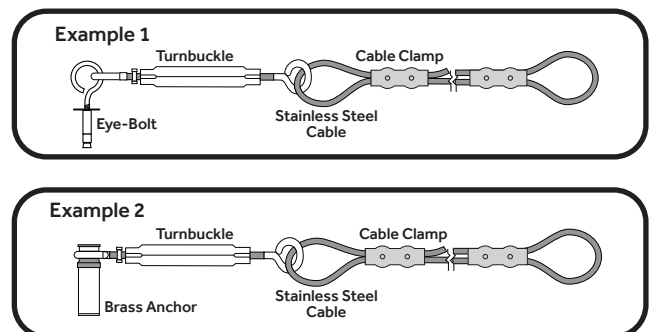

STEP 6

Attach one end of the Cable to one of the Turnbuckles using a cable clamp. Hook the Turnbuckle to the Stainless Steel Eye-Bolt.

STEP 7

Feed the other end of the cable through the Cable Anchor Bolts. Attach the Turnbuckle to the other end of the cable using the remaining Cable Clamp. Make sure the Turnbuckles are in the most extended position before attaching them to the Stainless Steel Eye-Bolts. Tighten the Turnbuckles so the cable is tight. The gap between the wall and the cover should be no more than 4". You may find you need more wall anchors to pull the cover closer.

STEP 8

Then, position the cover on the pool to begin installation. Attach the cover to the cable area first. Use the Snap Hooks on the underside of the cover to attach the cover to the cable.

STEP 9

Mark and install the anchors on the opposite side of the pool from the raised wall. Make sure they are straight and tight. Continue installing the cover using the instructions on page 2.